

**A**

# ZLATA

**SZF2D1S**

A	B	C	D
1	S383-00001	1626	446 3/4
2	S383-00002	1626	446 3/4
3	S383-00003	897	264 4/4
4	S383-11001	1904	540 1/4
5	S383-11002	1904	540 1/4
6	S383-22001	902	558 2/4
7	S383-22002	902	558 2/4
8	S383-33001	869	540 2/4
9	S383-99002	822	498 2/4
10	S383-99501	1931	447 1/4
11	ZP-5511	812	140 2/4
12	BP-507	500	140 2/4
13	BP-508	500	140 2/4
14	dr-863	863	22 2/4

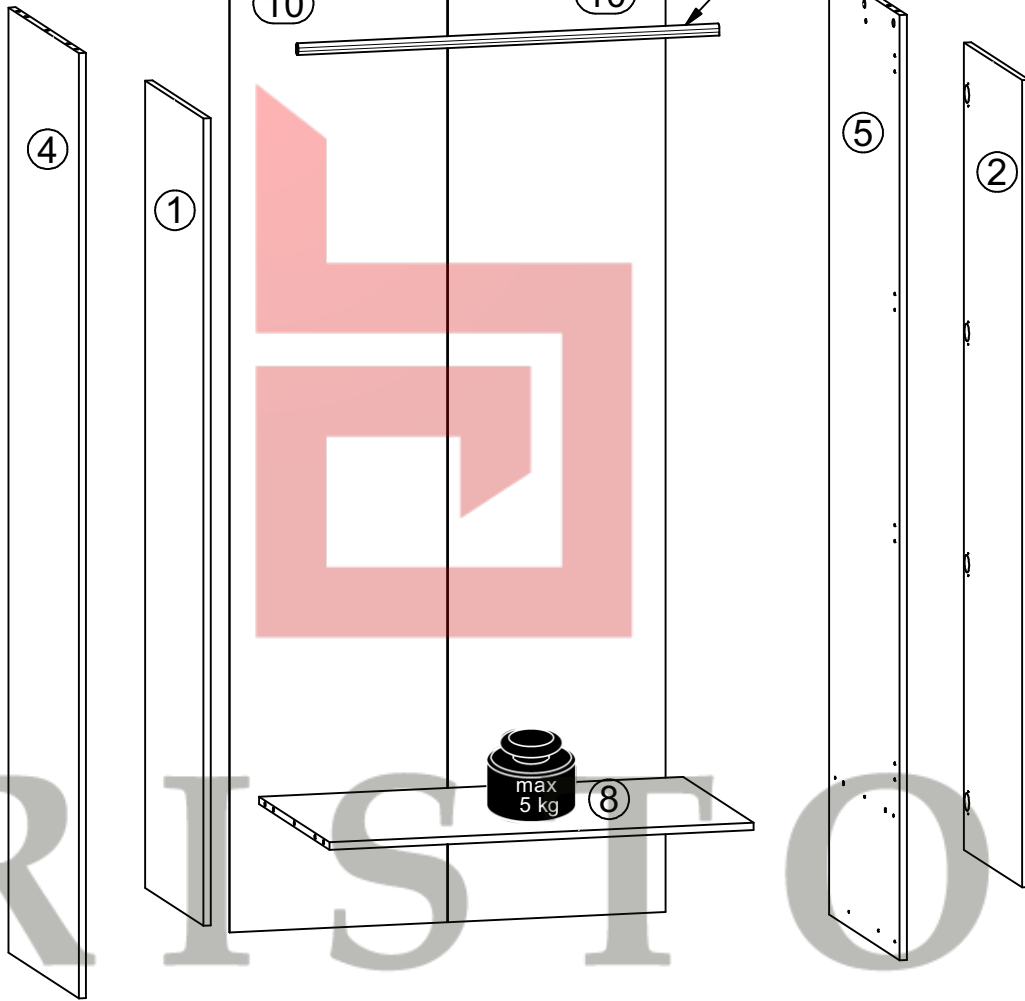
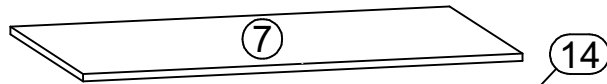
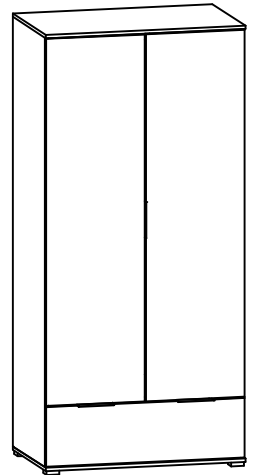
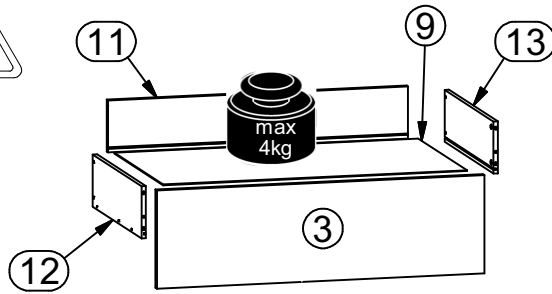

8x a44	8x b19	3x c409 128mm	6x e1 Ø7x50 mm	6x e19 Ø5x9 mm	14x e3 Ø6x13 mm	12x f1 Ø8x30 mm	4x f25 Ø6.5x40 mm	2x f9 Ø6x30 mm
4x k82\1	4x k82\2	65x l1	2x n1 h=22mm	1x n25 40x46x30/1.5	6x o21 silikon	2x p1 Ø3.5x13 mm	2x p25 Ø3.5x16 mm	2x p27 Ø3.5x13 mm
6x p93 Ø4x13 mm	16x r1 Ø15x12 mm #16	6x s2 Ø16	16x r42 20/11	1x t17 483 mm	1x w26\CL 500 mm	1x w26\CR 500 mm	1x w26\DL 500 mm	16x p51 Ø3.5x15 mm
1x w26\DR 500 mm	1x z1 4 mm					1x n26\1	1x p38 Ø3.5x16 mm	

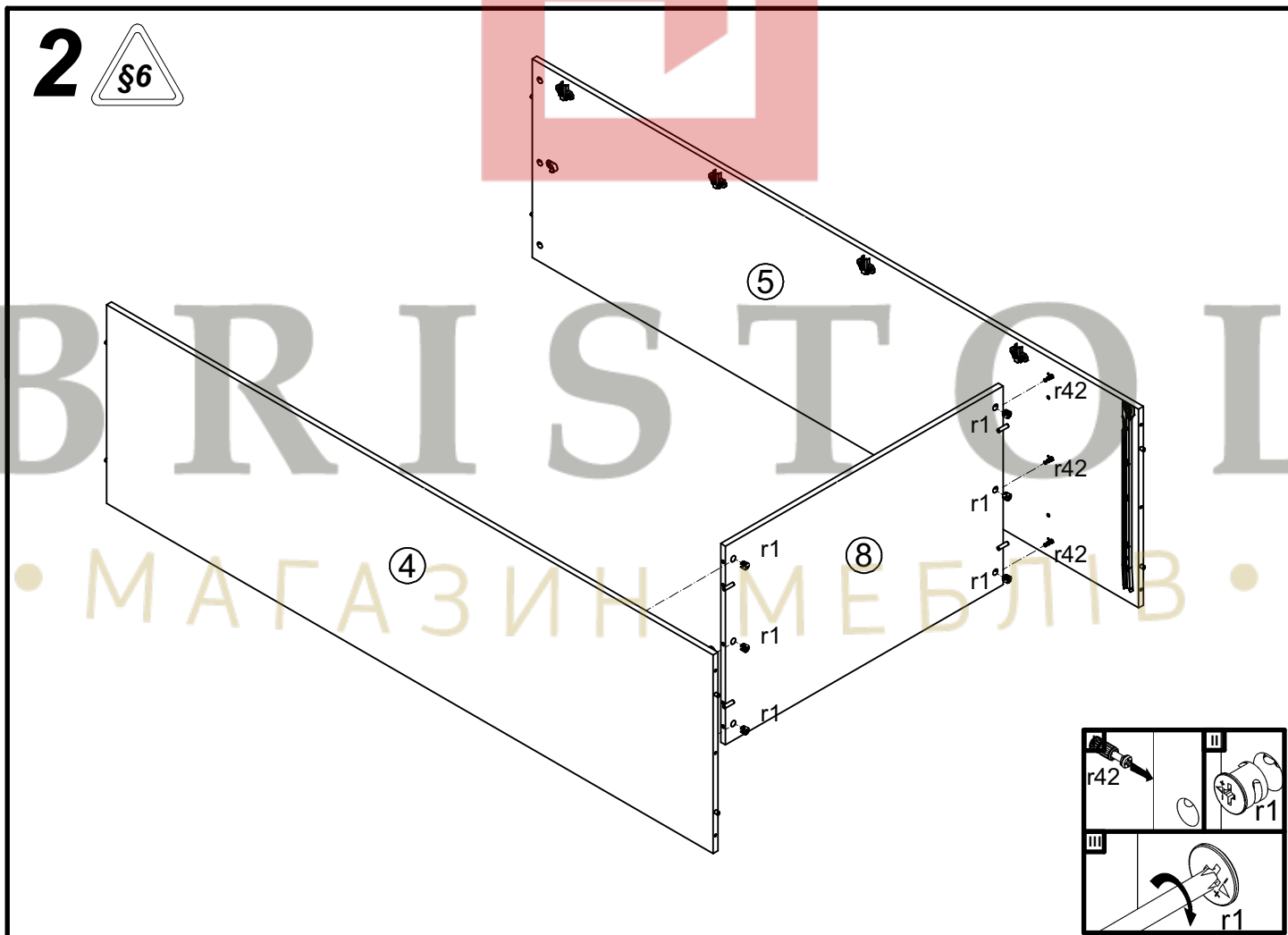
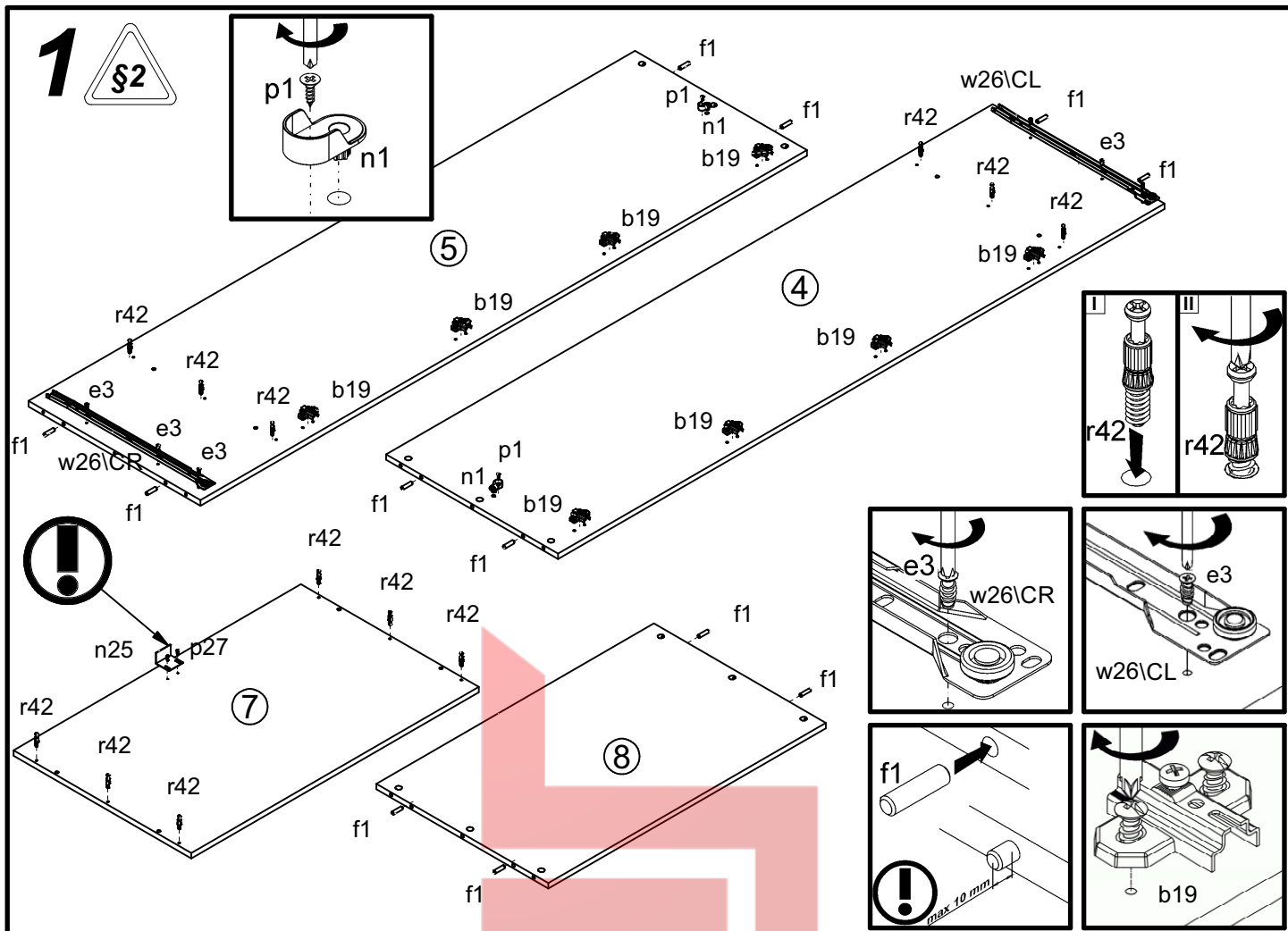

# 3

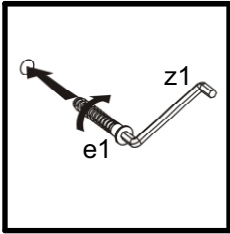
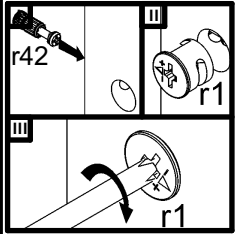
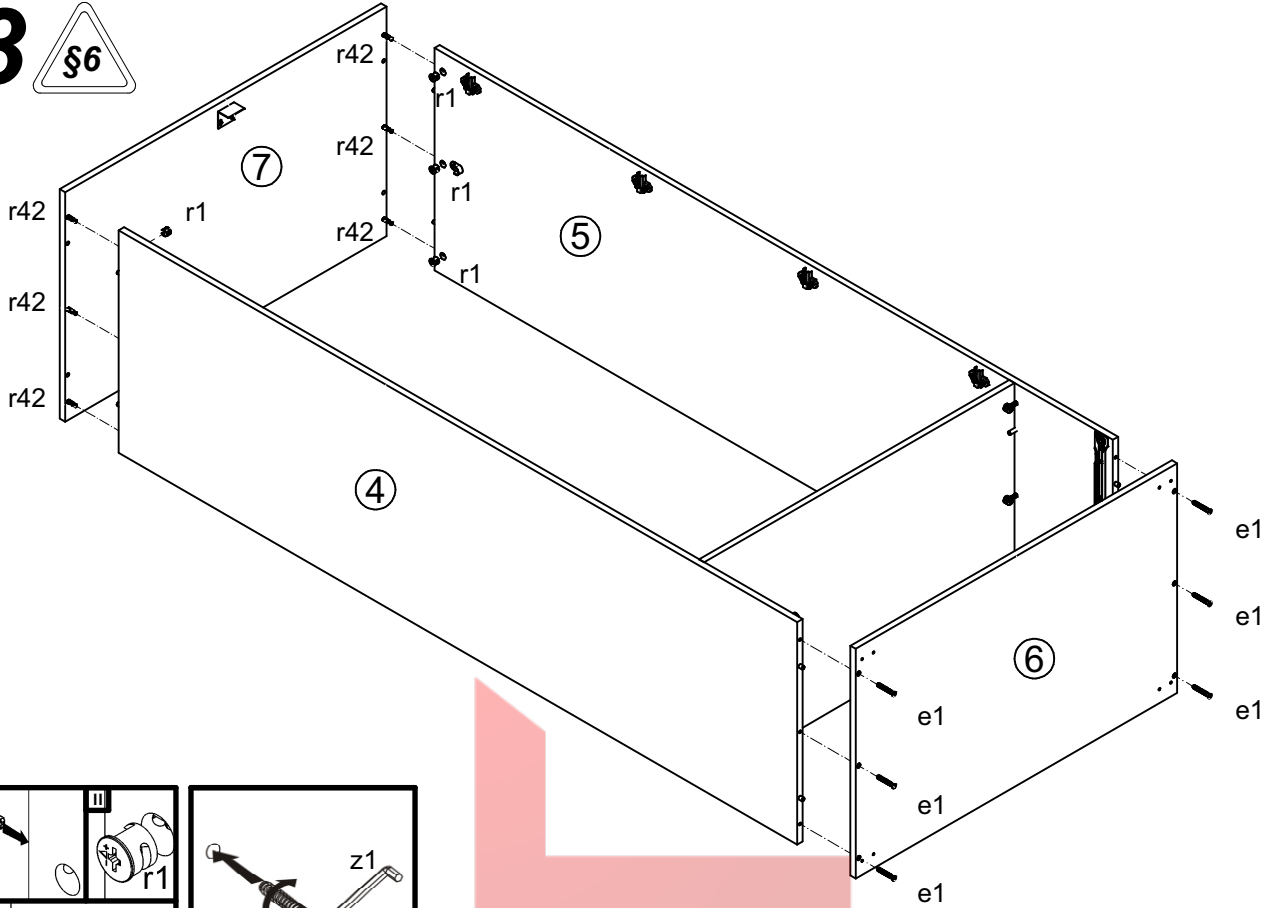

# 4

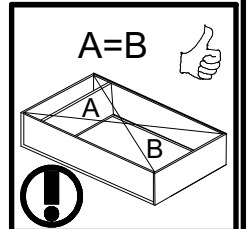
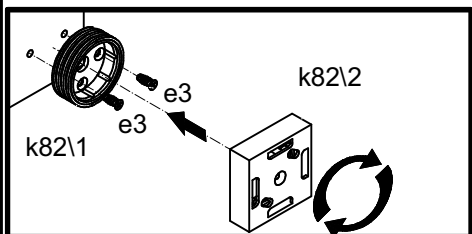
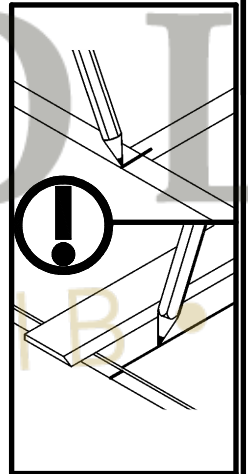
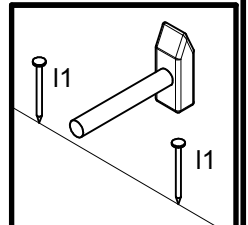
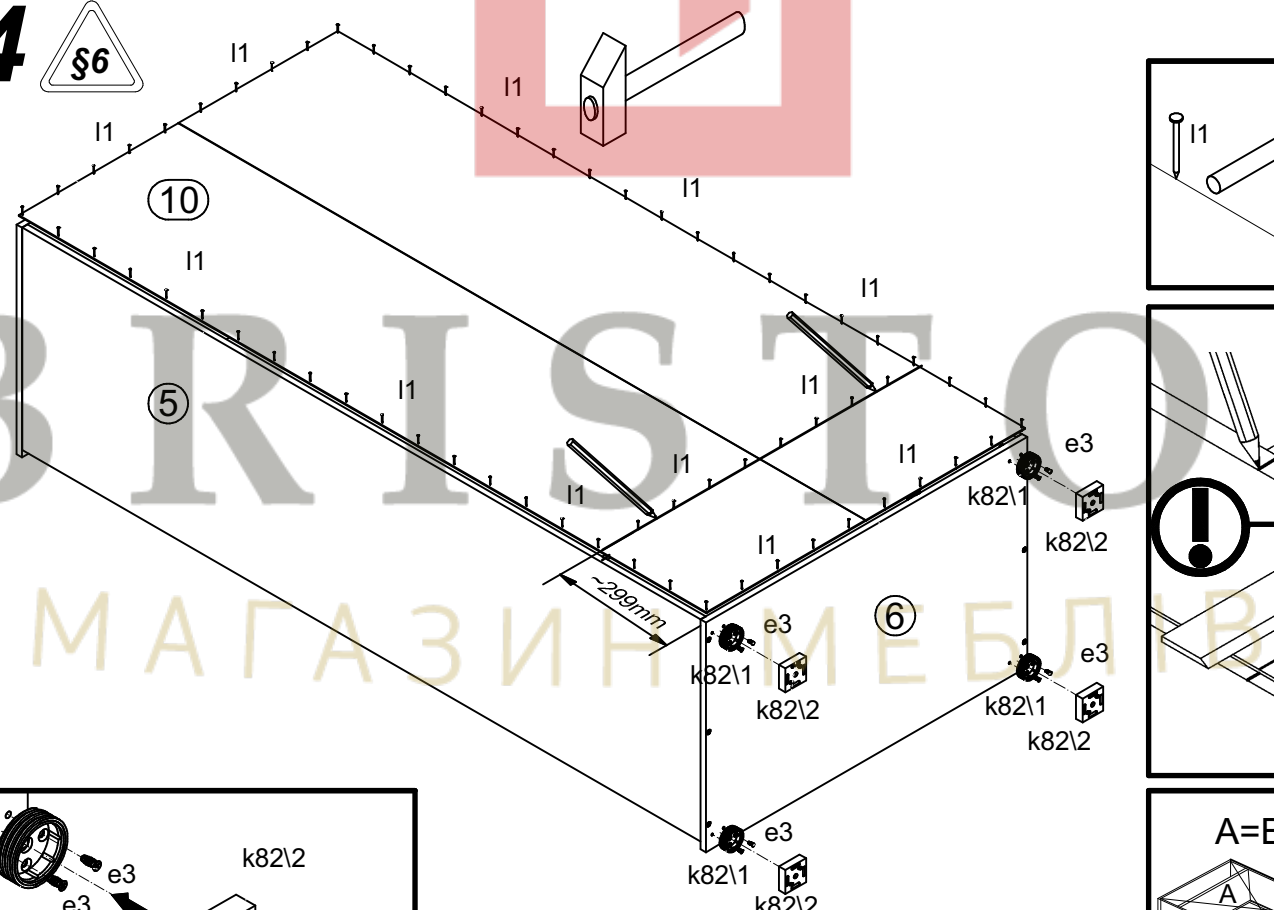

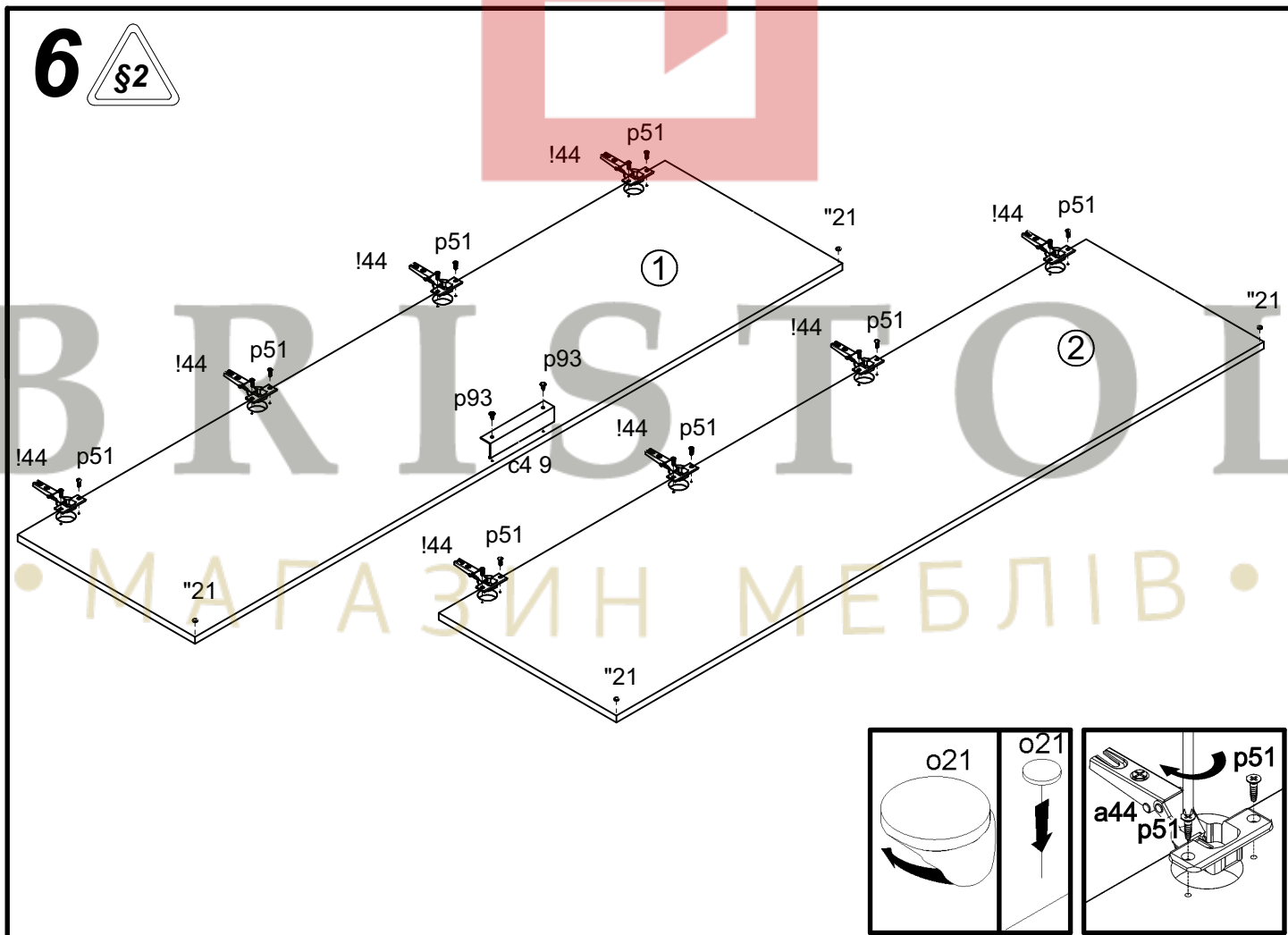
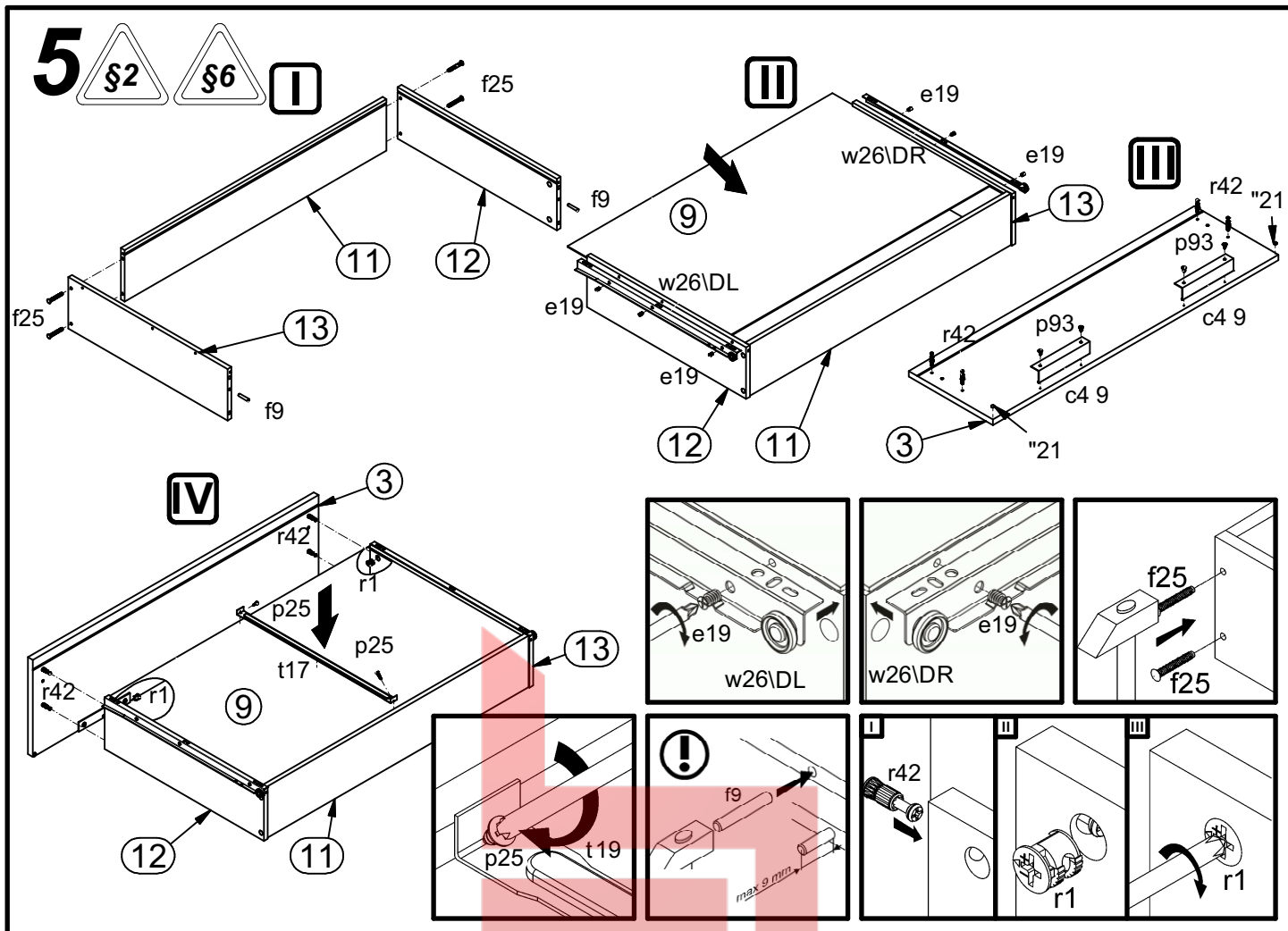

# 7

