

**A**

# ZLATA

**REG1W3D**

A	B	C	D	
1	S383-00012	606	496	3/3
2	S383-00013	1284	496	3/3
3	S383-00016	606	396	3/3
4	S383-00017	1284	396	3/3
5	S383-11007	1904	385	1/3
6	S383-11018	1904	385	1/3
7	S383-11022	1904	385	1/3
8	S383-22013	900	403	2/3
9	S383-22014	900	403	2/3
10	S383-33009	477	382	2/3
11	S383-33010	476	380	2/3
12	S383-33012	374	382	2/3
13	S383-33013	373	380	2/3
14	S383-5004	475	350	3/3
15	S383-99505	1931	395	1/3
16	S383-99532	1931	498	1/3

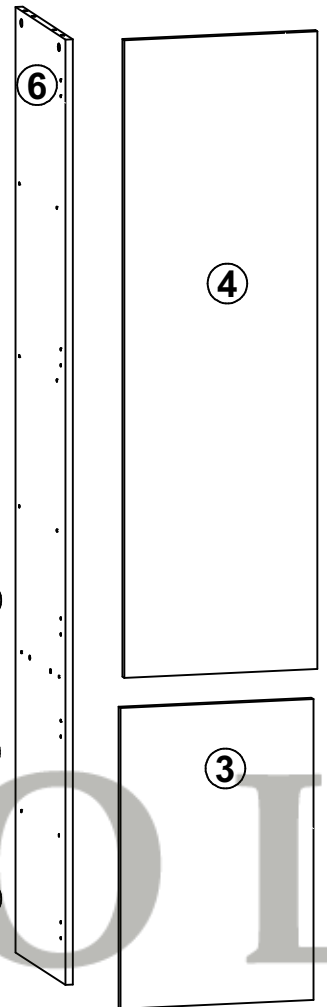
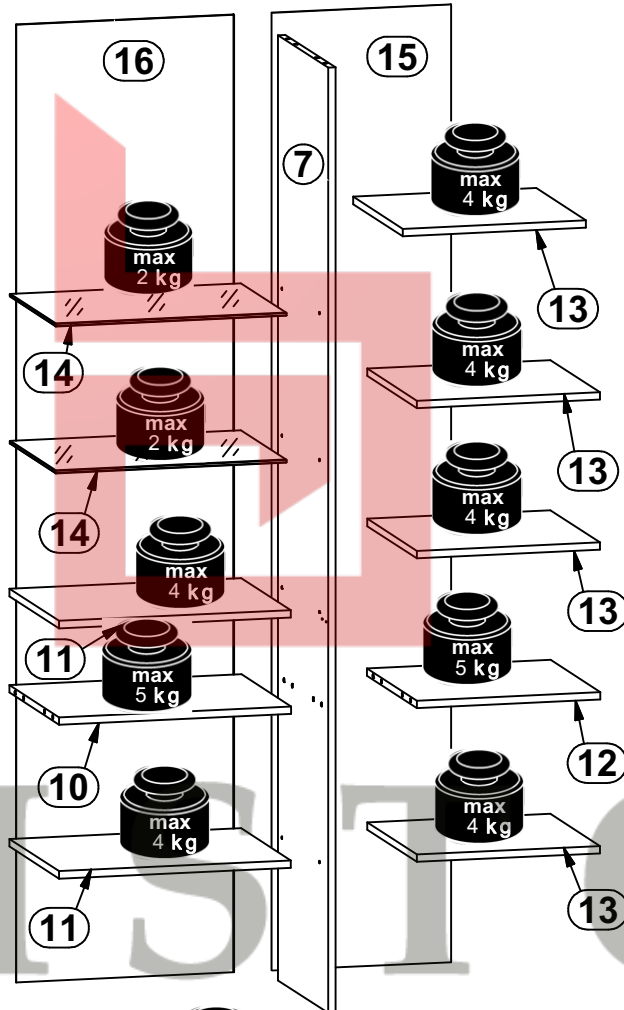
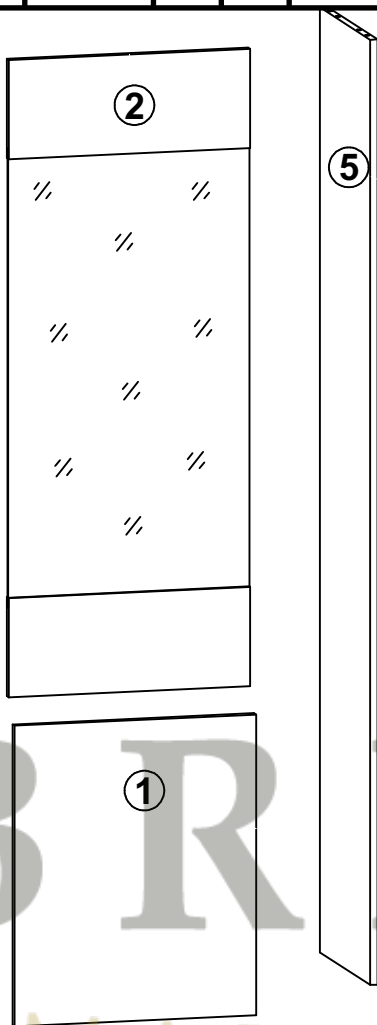
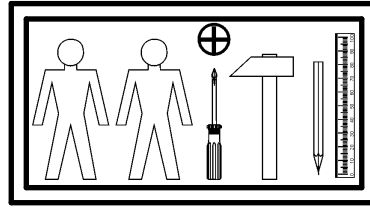

9x a44	9x b19	2x c409 128mm	24x d1 Ø5x17 mm	8x d3 Ø5x17 mm	6x e1 Ø7x50 mm	10x e3 Ø6x13 mm	20x f1 Ø8x30 mm	5x k82\1
5x k82\2	75x l1	18x p51 Ø3.5x15 mm	4x p93 Ø4x13 mm	14x r1 Ø15x12 mm #16	2x r10	10x r42 20x11	2x z28\1	2x z28\2 82x9.5x16.5mm
2x z28\3 20x20x1.5 mm	6x z28\4 Ø3x12mm	8x o21 silikon	6x s2 Ø16	1x z1 4 mm	8x n108 20x13x3.5x1	8x p55 Ø2.9x16 mm	1x n26\1	1x p38 Ø3.5x16 mm

# 1

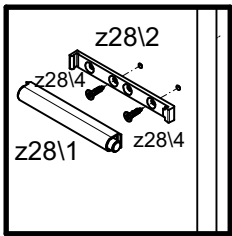
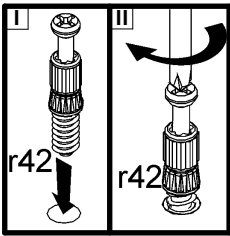
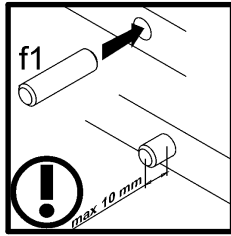
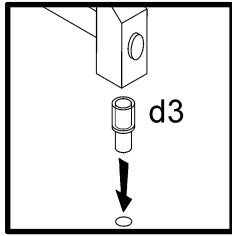
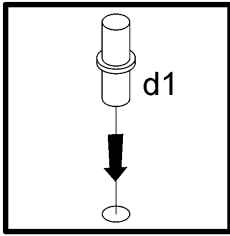
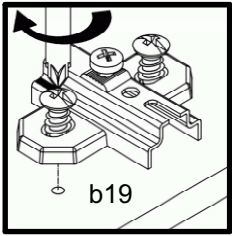
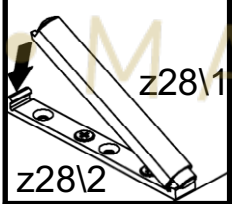
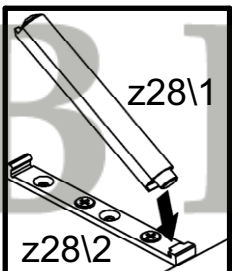
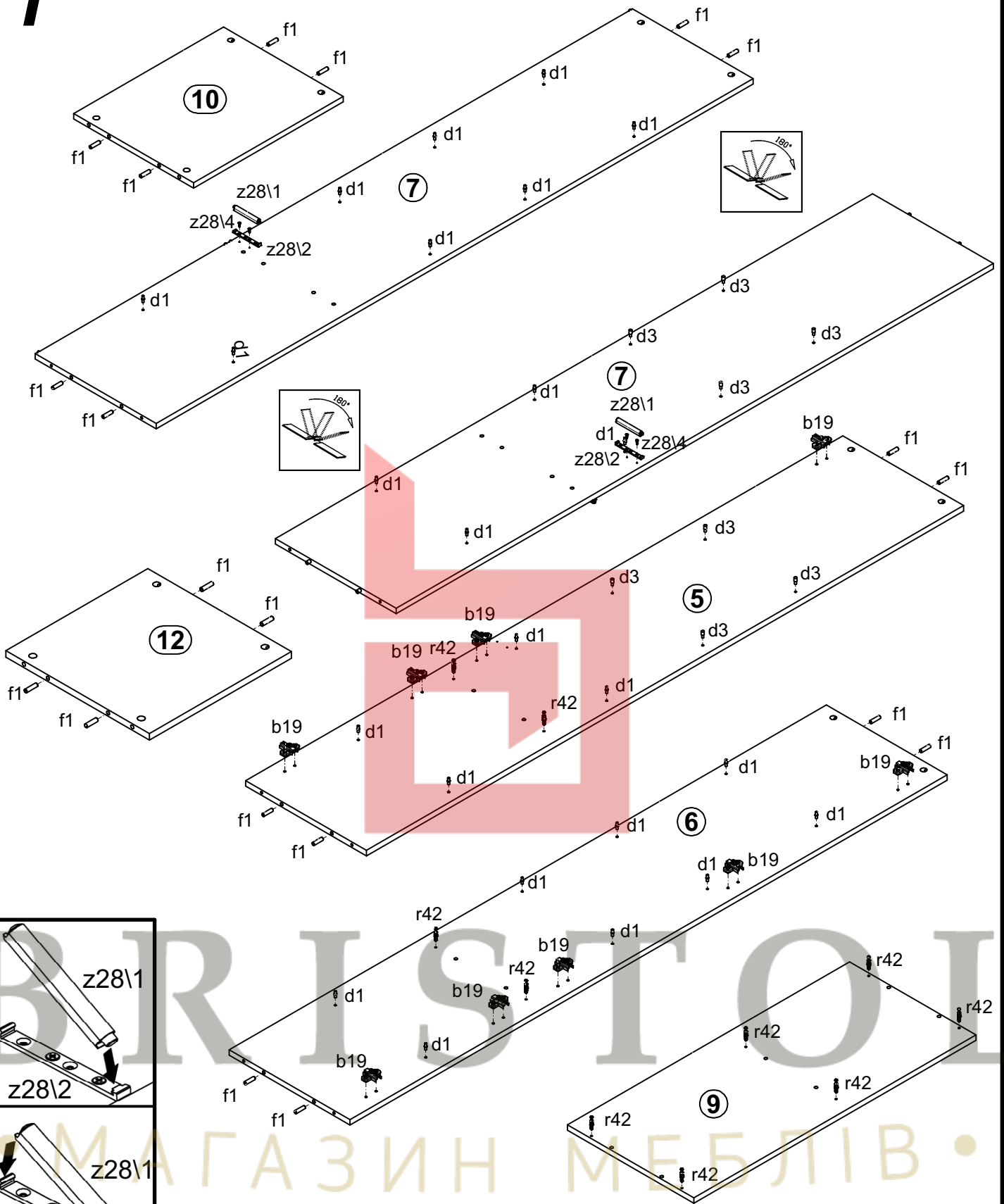

# 2

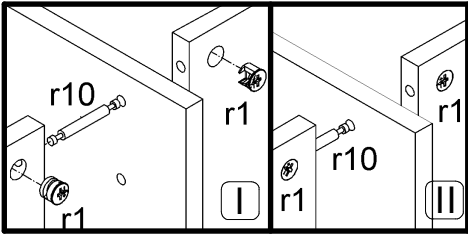
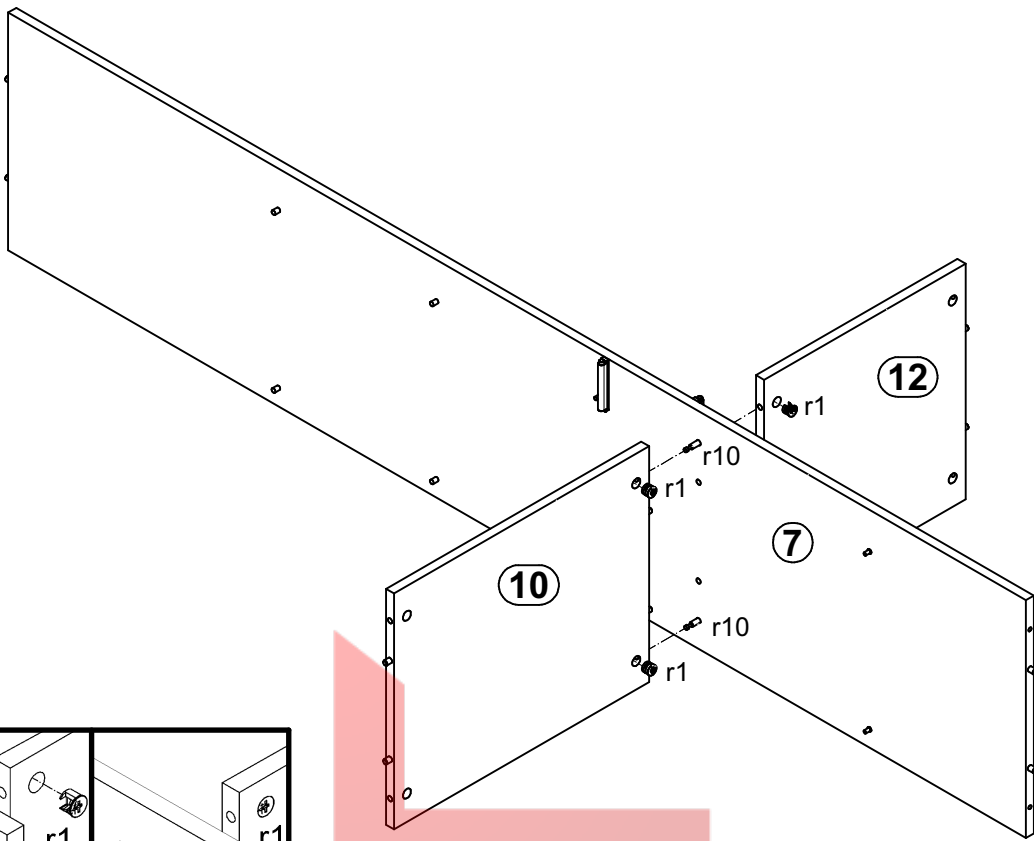

# 3

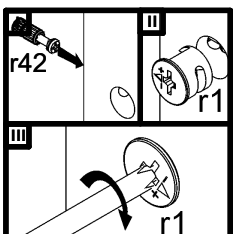
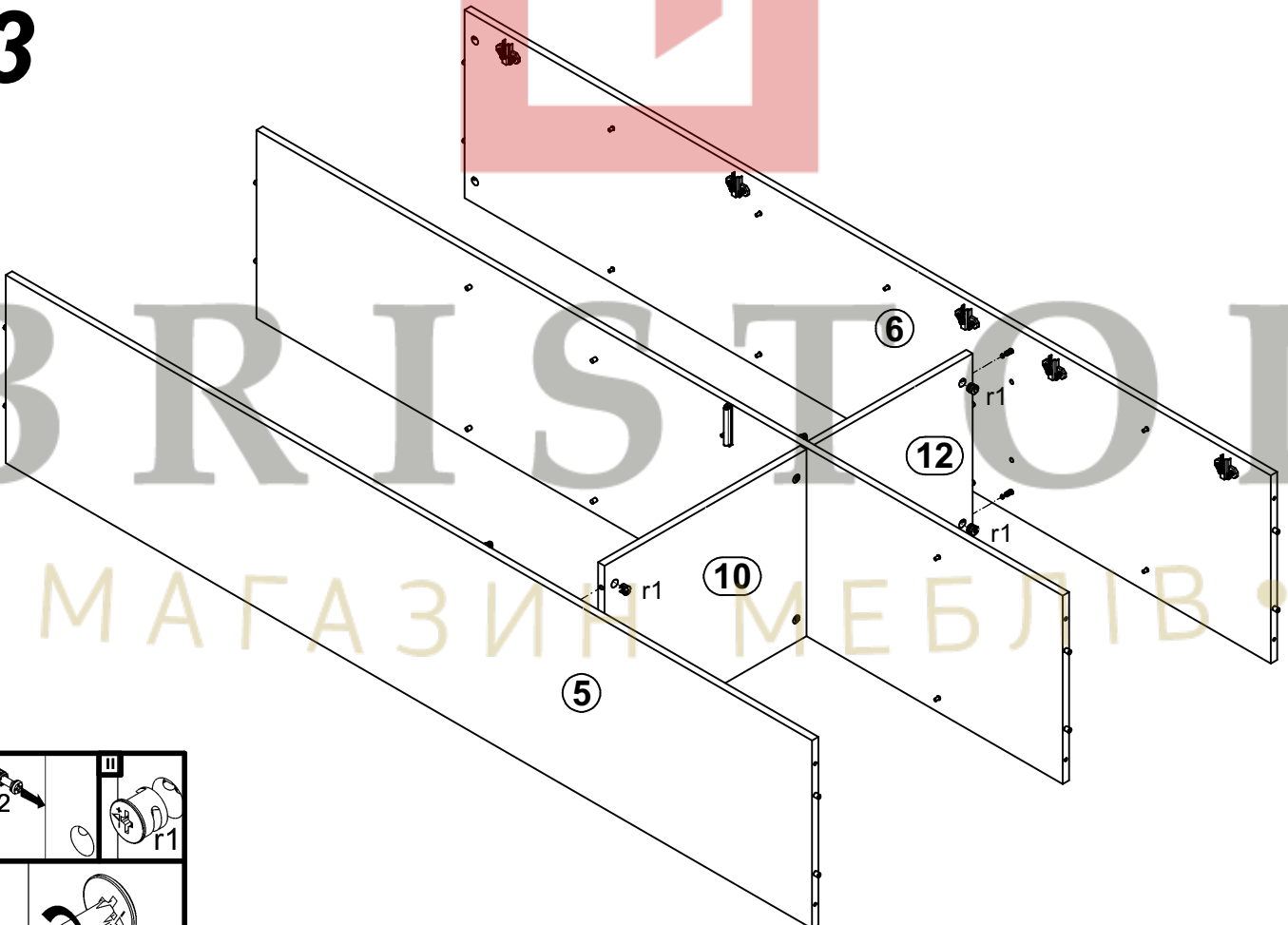

# 4

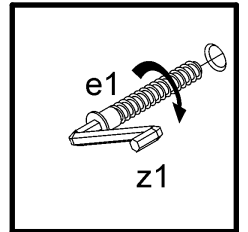
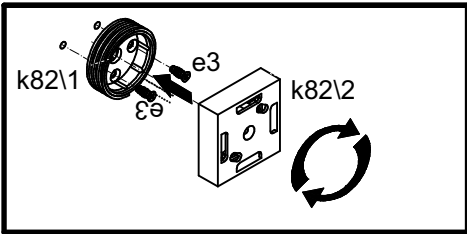
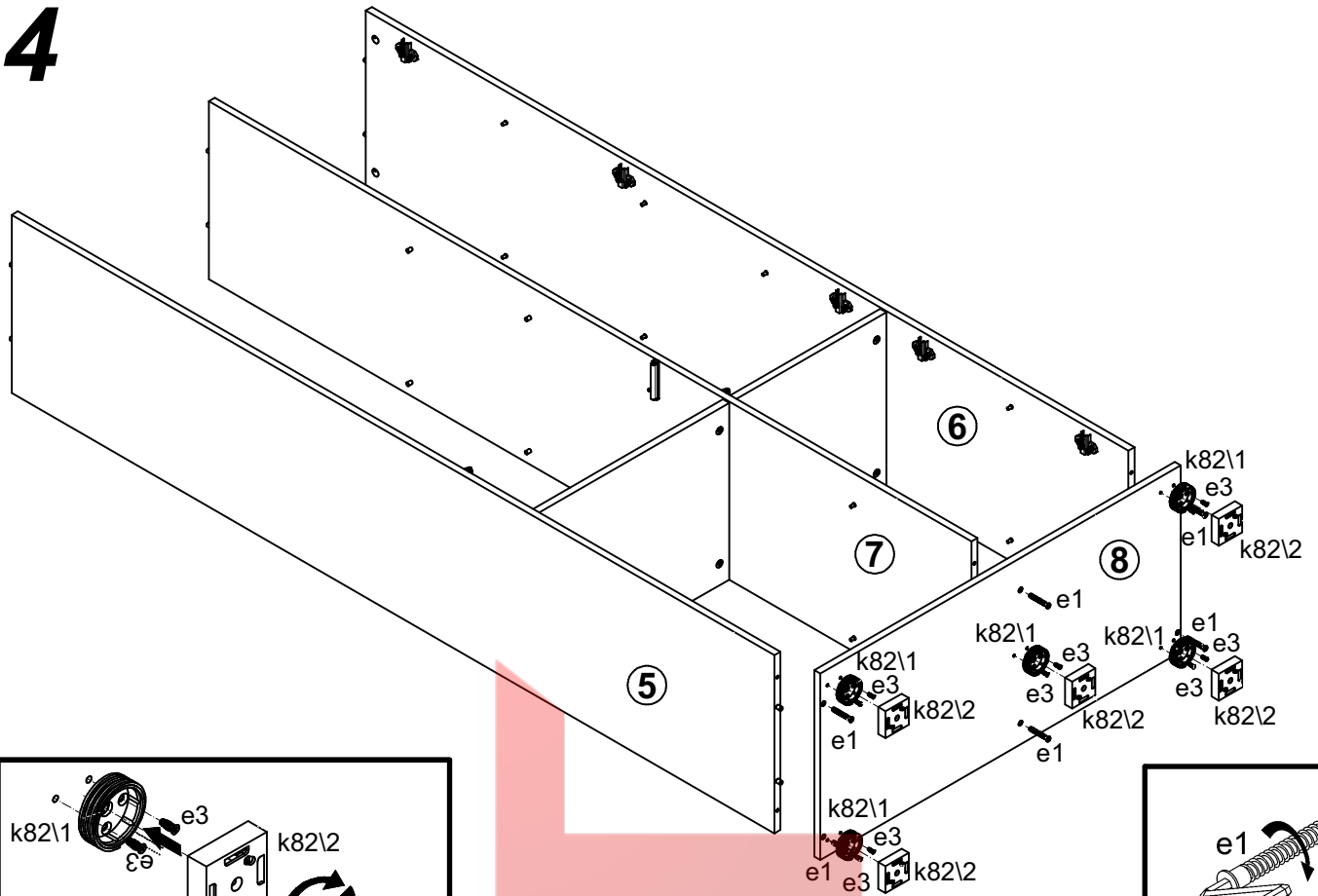

# 5

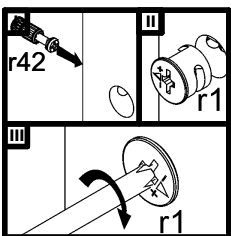
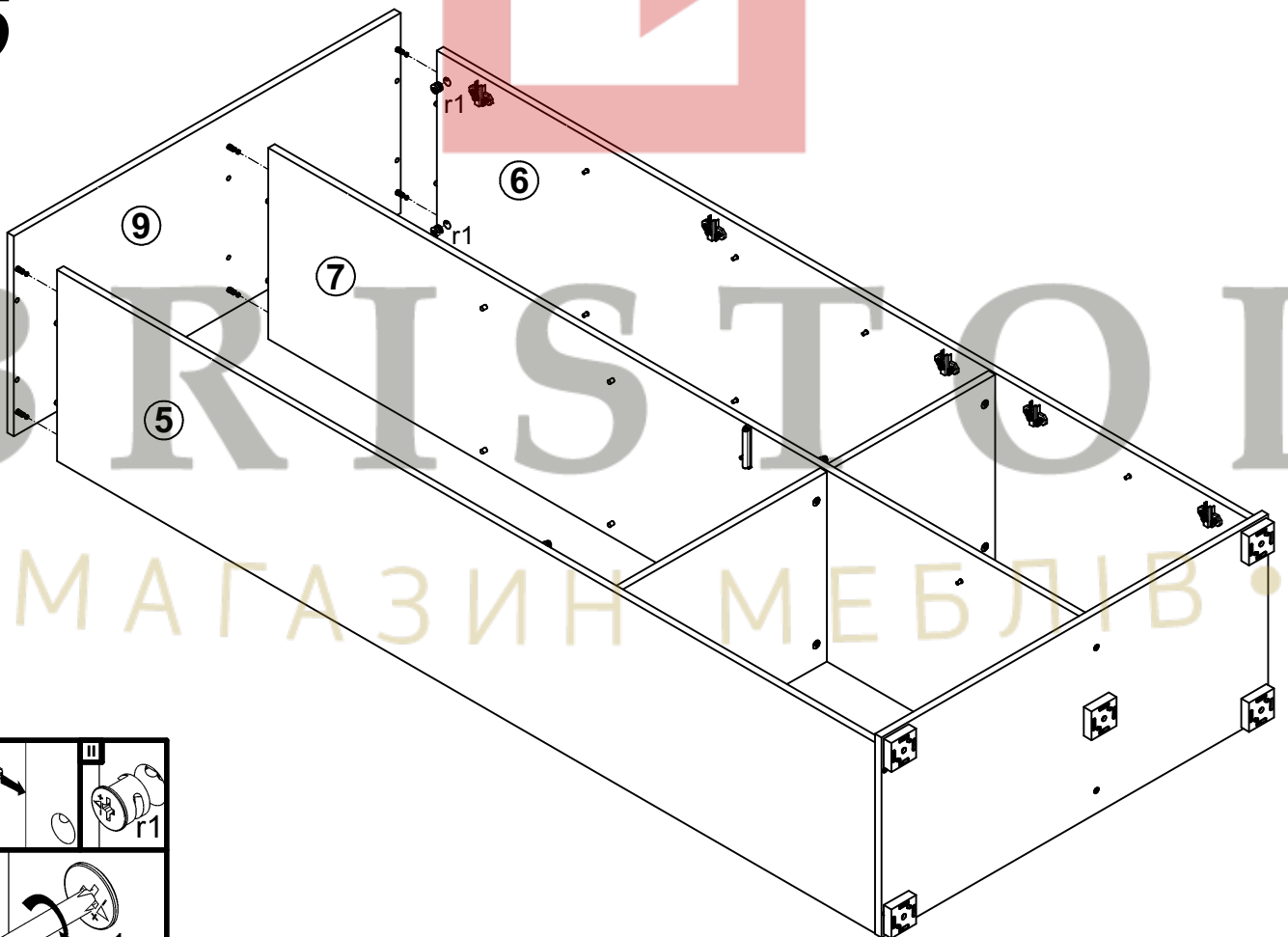

# 6

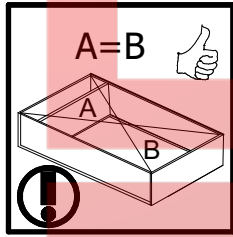
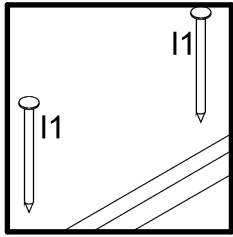
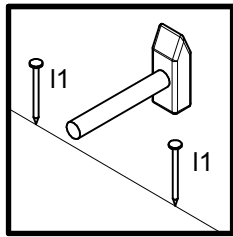
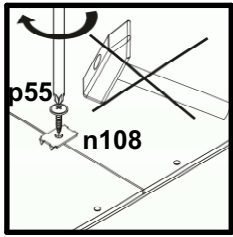
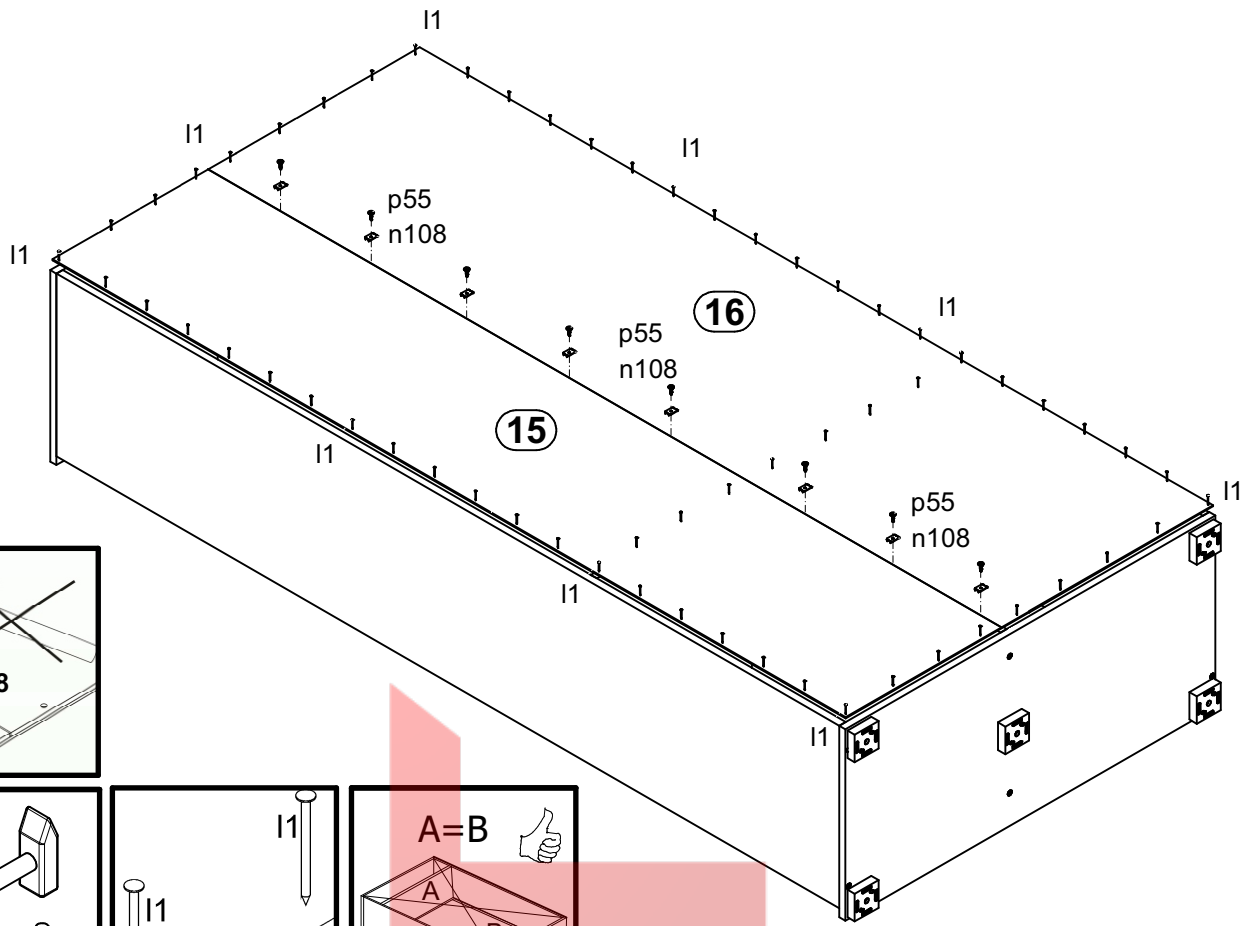

# 7

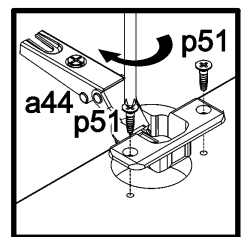
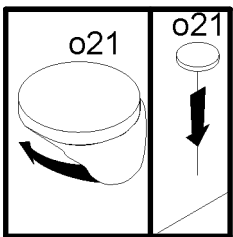
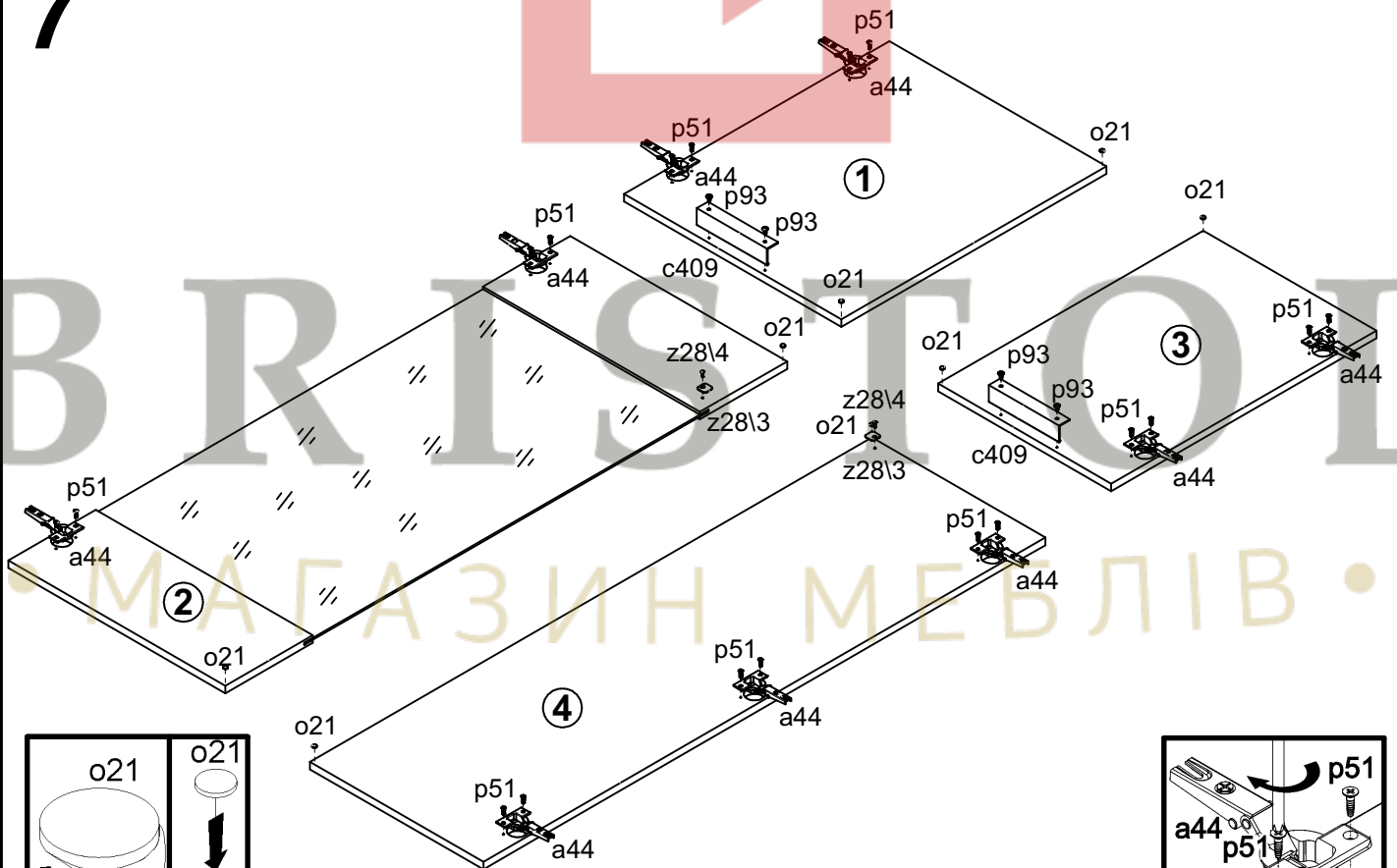

8

